

Intrafix® Handling Poster

Best practice recommendation to prime Intrafix® Primeline and Intrafix® SafeSet in combination with semirigid container/bags.

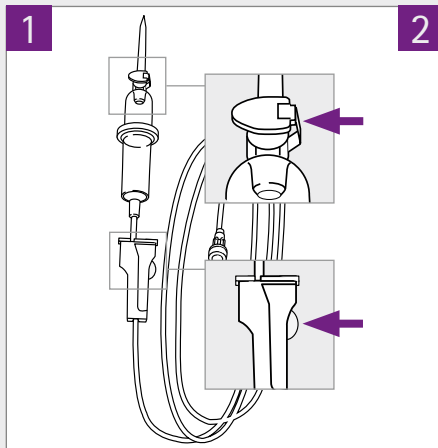

Unwrap the IV-set and check whether the green **air vent cap is closed** and the **roller clamp is open**.

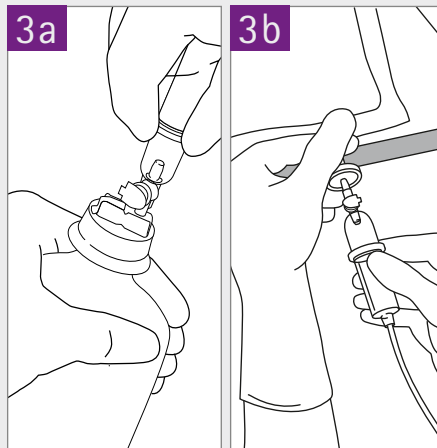

Spike the semirigid container/bag.

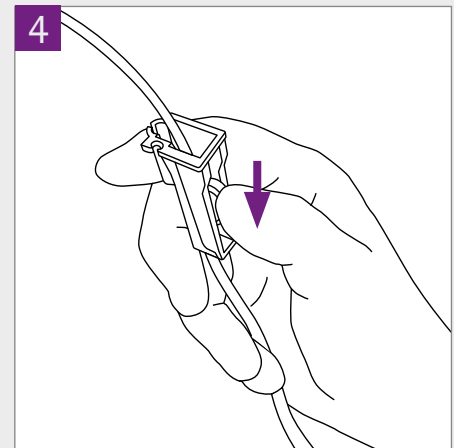

Close the roller clamp.

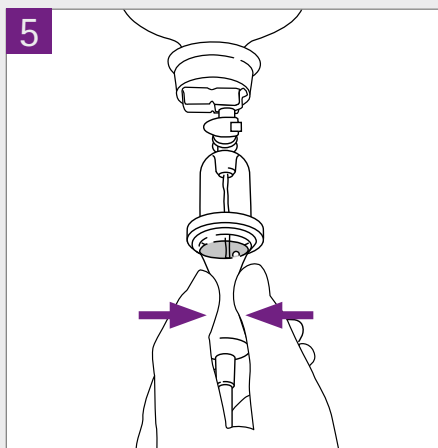

Turn the IV-system upside down. **Squeeze impulsively the drip chamber** and bring fluid level up to the ring of the drip chamber.

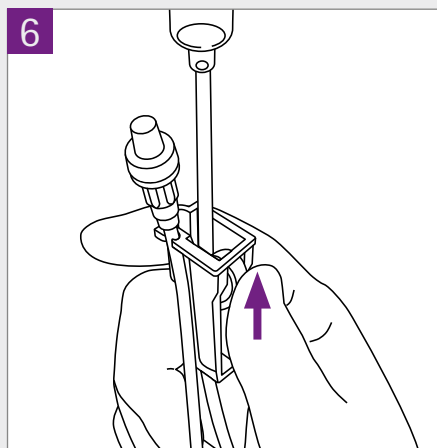

Open roller clamp.

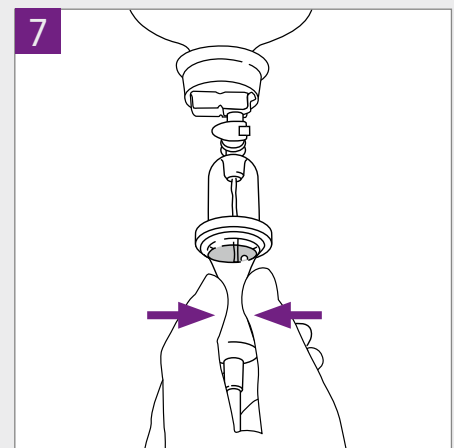

Squeeze the drip chamber impulsively once again.

www.safeinfusiontherapy.com